

**NYC DEPARTMENT OF FINANCE
OFFICE OF THE CITY REGISTER**

This page is part of the instrument. The City Register will rely on the information provided by you on this page for purposes of indexing this instrument. The information on this page will control for indexing purposes in the event of any conflict with the rest of the document.

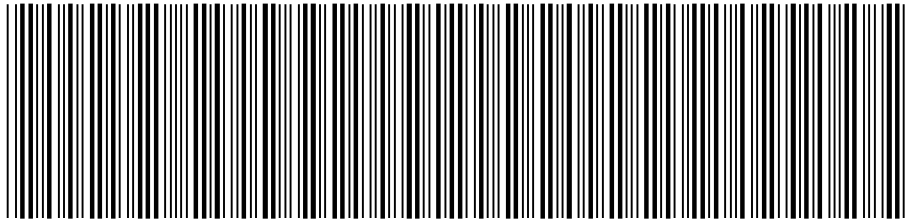

2013010701748002001E28EF

RECORDING AND ENDORSEMENT COVER PAGE

PAGE 1 OF 3

Document ID: 2013010701748002 Document Date: 12-21-2012 Preparation Date: 01-07-2013
Document Type: ZONING LOT DESCRIPTION
Document Page Count: 2

<p>PRESENTER: LANDMARK ABSTRACT AGENCY 207 ROCKAWAY TURNPIKE HOLD FOR PICK-UP-RAPID LAWRENCE, NY 11559 212-805-8120 jrekant@laatitle.com</p>	<p>RETURN TO: LANDMARK ABSTRACT AGENCY 207 ROCKAWAY TURNPIKE HOLD FOR PICK-UP-RAPID LAWRENCE, NY 11559 212-805-8120 jrekant@laatitle.com</p>
---	---

PROPERTY DATA

Borough	Block	Lot	Unit	Address
BROOKLYN	250	28	Entire Lot	172 MONTAGUE STREET
Property Type: COMMERCIAL REAL ESTATE				

CROSS REFERENCE DATA

CRFN _____ or Document ID _____ or Year _____ Reel _____ Page _____ or File Number _____

PARTIES

PARTY ONE:
BH 1 CD LLC
172-174 MONTAGUE STREET
BROOKLYN, NY 11201

FEES AND TAXES

Mortgage			Filing Fee:		
Mortgage Amount:	\$	0.00		\$	0.00
Taxable Mortgage Amount:	\$	0.00	NYC Real Property Transfer Tax:		
Exemption:				\$	0.00
TAXES: County (Basic):	\$	0.00	NYS Real Estate Transfer Tax:		
City (Additional):	\$	0.00		\$	0.00
Spec (Additional):	\$	0.00			
TASF:	\$	0.00			
MTA:	\$	0.00			
NYCTA:	\$	0.00			
Additional MRT:	\$	0.00			
TOTAL:	\$	0.00			
Recording Fee:	\$	47.00			
Affidavit Fee:	\$	0.00			



**RECORDED OR FILED IN THE OFFICE
OF THE CITY REGISTER OF THE
CITY OF NEW YORK**

Recorded/Filed 01-23-2013 10:51
City Register File No.(CRFN):
2013000029410

Annette McMill

City Register Official Signature

EXHIBIT III

ZONING LOT DESCRIPTION AND OWNERSHIP STATEMENT BY
BUILDING DEPARTMENT PERMIT APPLICANT
AND TO BE RECORDED IN THE
COUNTY CLERK'S OR REGISTER'S OFFICE

BH 1 CD LLC, 172-174 Montague Street Brooklyn, NY 11201 an applicant for present or future permits pursuant to the Zoning Resolution of the City of New York, effective as of December 15, 1961, and as subsequently amended states that the zoning lot to which the aforementioned permit or permits pertain are shown on the Tax Map of the City of New York, County of Kings, as Block 250 Lot 28 as shown on the Tax Map of the City of New York, and is more particularly described as:

ALL that certain plot, piece or parcel of land, with the buildings and improvements thereon erected, situate, lying and being in the Borough of Brooklyn, County of Kings, City and State of New York, bounded and described as follows:

BEGINNING at a point on the southwesterly side of Montague Street (formerly Montague Place) distant 50 feet southeasterly from the corner formed by the intersection of the southwesterly side of Montague Street and the southeasterly side of Clinton Street;

RUNNING THENCE southwesterly parallel with Clinton Street and part of the distance through a party wall, 100 feet;

THENCE southeasterly parallel with Montague Street, 50 feet;

THENCE northeasterly parallel with Clinton Street, 100 feet to southwesterly side of Montague Street;

THENCE northwesterly along the southwesterly side of Montague Street, 50 feet to the point or place of BEGINNING.

That the said premises' are known as and by street address: 172 Montague Street Brooklyn, NY as shown on the following diagram:

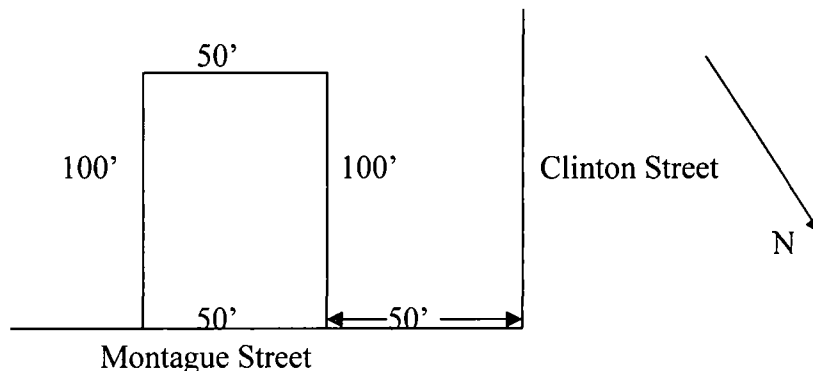

The above described zoning lot is presently owned by

BLOCK/LOT

NAME

ADDRESS

250/28

BH 1 CD LLC

172-174 Montague Street
Brooklyn, NY 11201

IN WITNESS WHEREOF the applicant for permit has executed this instrument this
21st day of Dec., 2012.

By: _____

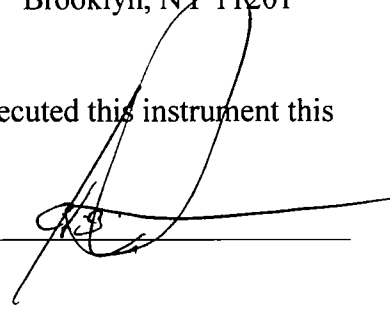

CERTIFICATE OF ACKNOWLEDGMENT

SEAL

STATE OF NEW YORK, COUNTY OF New York } ss:

On the 21st day of Dec., 2012, before me, the undersigned, personally appeared CHARLES DAYAN, personally known to me or proved to me on the basis of satisfactory evidence to be the individual (s) whose name (s) is (are) subscribed to the within instrument and acknowledged to me that he/she/they executed the same in his/her/their capacity(ies), and that by his/her/their signature(s) on the instrument the individual(s), or the person upon behalf of which the individual(s) acted, executed the instrument.

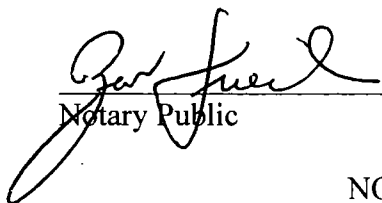

Notary Public

ZEV FRIEDMAN
NOTARY PUBLIC, State of New York
No. 30-4953782
Qualified in Nassau County
Commission Expires July 31, 2013

NOTE: Section C26-110.2 subdivision (a) Paragraph (1) of the Administrative Code requires submission of the accurate lot diagram in accordance with an attached boundary survey made by a licensed surveyor, which need not be recorded but which must be submitted with the application for the permit.

Record & Return to: